

# PRODUCT SUBMITTAL

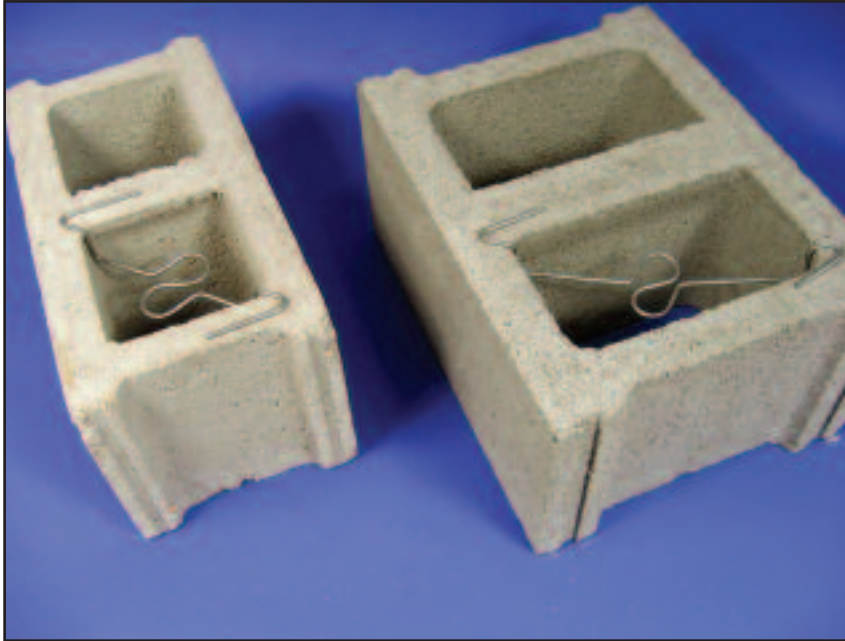

## CoreLock (pat. pending)



### Description:

- Rebar positioner is "seated" 1-1/4" deep into core of CMU.
- Diagonal placement in block insures rebar is automatically centered in core every time and prevents any movement.
- One-piece, no-weld design. Available in 9 gauge hot dipped and mill galvanized finishes.
- Does not interfere with installation of wire joint reinforcement
- Available for 8 and 12 inch block

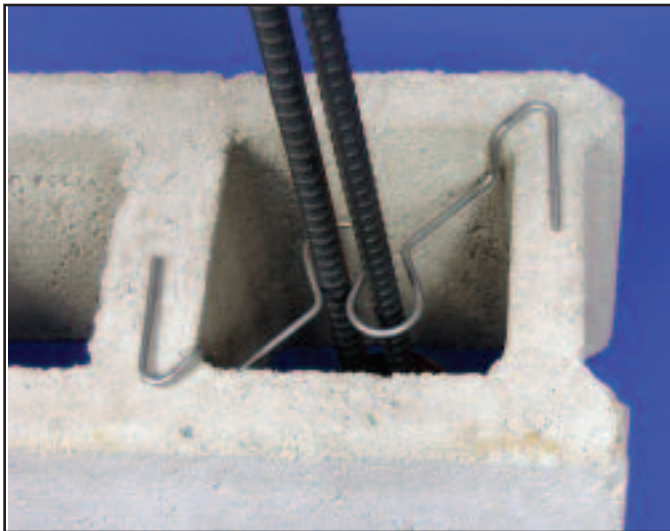

Approvals:

Comments:

#### Corporate Office

400 Roundtree Rd • PO Box 240988 • Charlotte, NC 28224  
704.525.5554 • 800.849.6722 • Fax 704.525.3761

#### Memphis Plant

2365 Harbor Ave. • PO Box 13124 • Memphis, TN 38113  
901.775.9444 • 800.441.8359 • Fax 901.775.9449

[www.wirebond.com](http://www.wirebond.com)