

PRODUCT SUBMITTAL



Plumb-Rite PATENT # 6,293,066B1

Description:

Plumb-Rite is a T-shaped PVC product that assists in keeping vertical joints in precise alignment where control joints and expansion joints are used in a masonry wall. Plumb-Rite is rigid enough to keep a 3/8" vertical joint consistently straight. It is flexible enough -- with a special slotted stem -- to allow for expansion of the brick.

Plumb-Rite may be attached to wood, steel, and block back-ups with either nails, screws or mastic. When insulation is used in the cavity, foam board adhesive is simply applied to the back of the Plumb-Rite and adhered to the insulation.

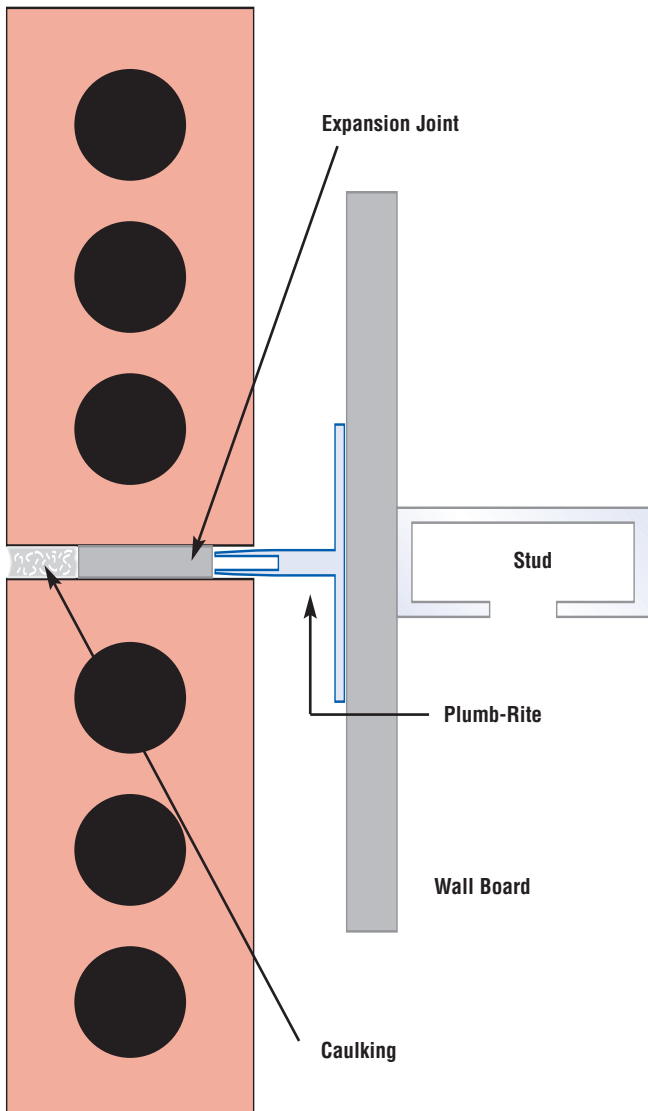
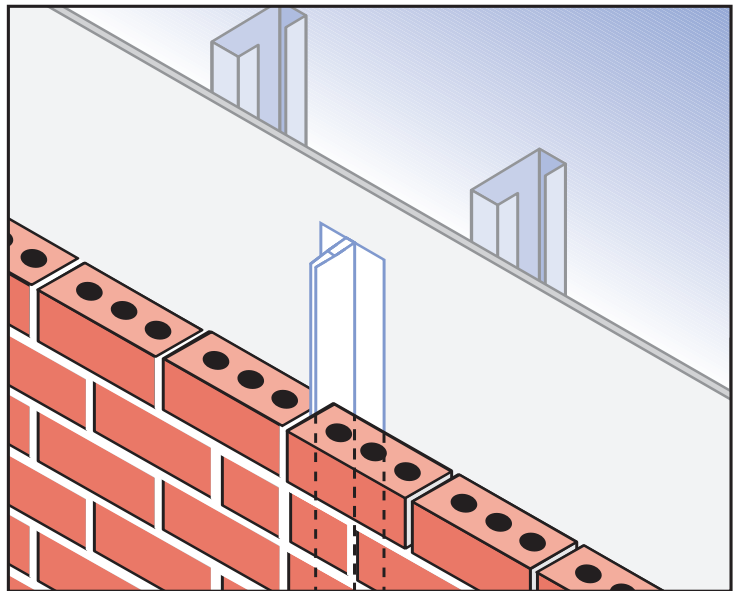

- Fast and simple installation.
- Insures that vertical joint is uniform where control joint and expansion joint are used in masonry.
- Uniformity enhances appearance of wall.
- Saves time and money. Once Plumb-Rite is installed, it isn't necessary to plumb joint again. Increases job productivity.
- Replaces use of metal, boards, lines, or other materials. Avoids pulling metal or wood guides up the wall and risking quality workmanship.
- It isn't necessary to clean out the joint. Instead, the trowel is run up the vertical slot to insure movement for expansion of brick.
- Not necessary to use experienced mason in control joint areas.
- Available in 10' lengths. May be saw cut at the job site. Packed 6/box.

Approvals:

Comments:

Corporate Office

400 Roundtree Road PO Box 240988 Charlotte, NC 28224
704 525.5554 800 849.6722 Fax 704 525.3761

Memphis Plant

2365 Harbor Avenue PO Box 13124 Memphis, TN 38113
901 775.9444 800 441.8359 Fax 901 775.9449

www.wirebond.com